

Floor Materials:
 2"x4"x4' (5)
 4'x6'x1/2" ply (1)

Awning Materials
 1"x8"x8" (14)
 (10' total)

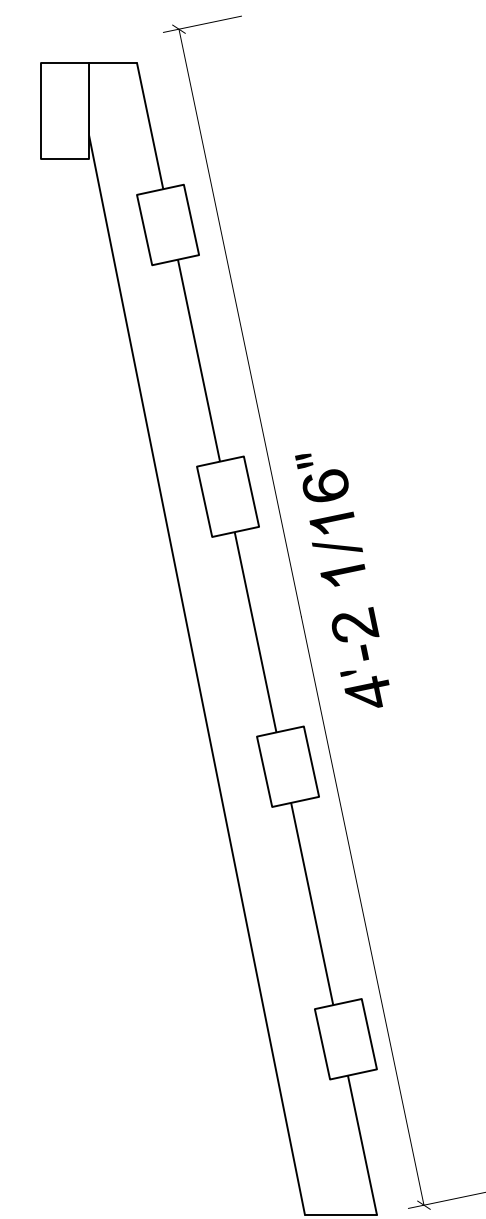
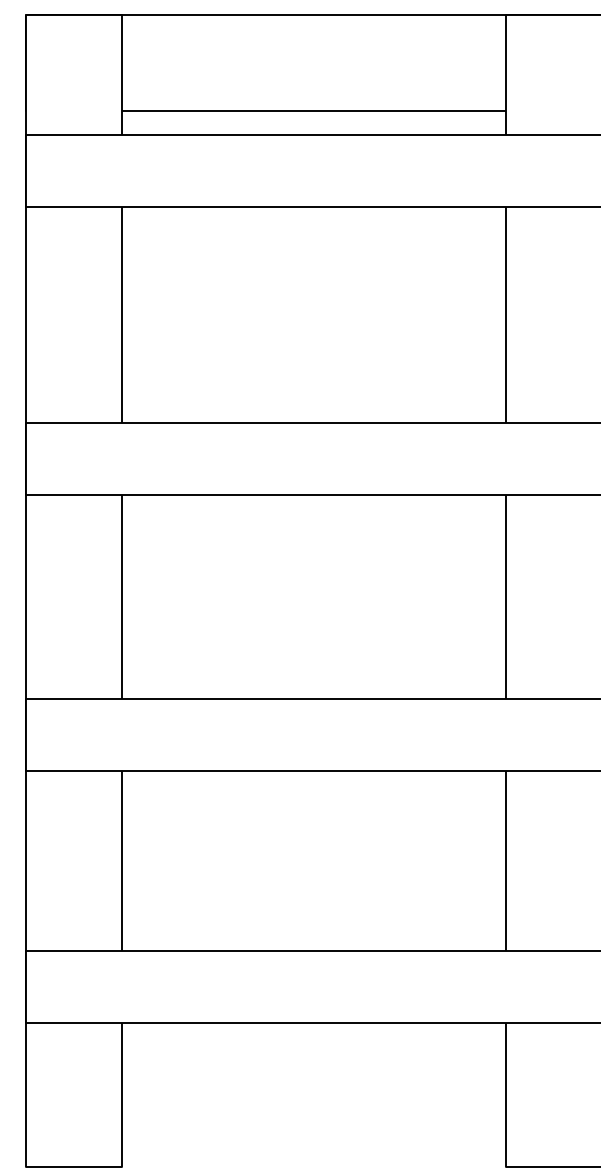
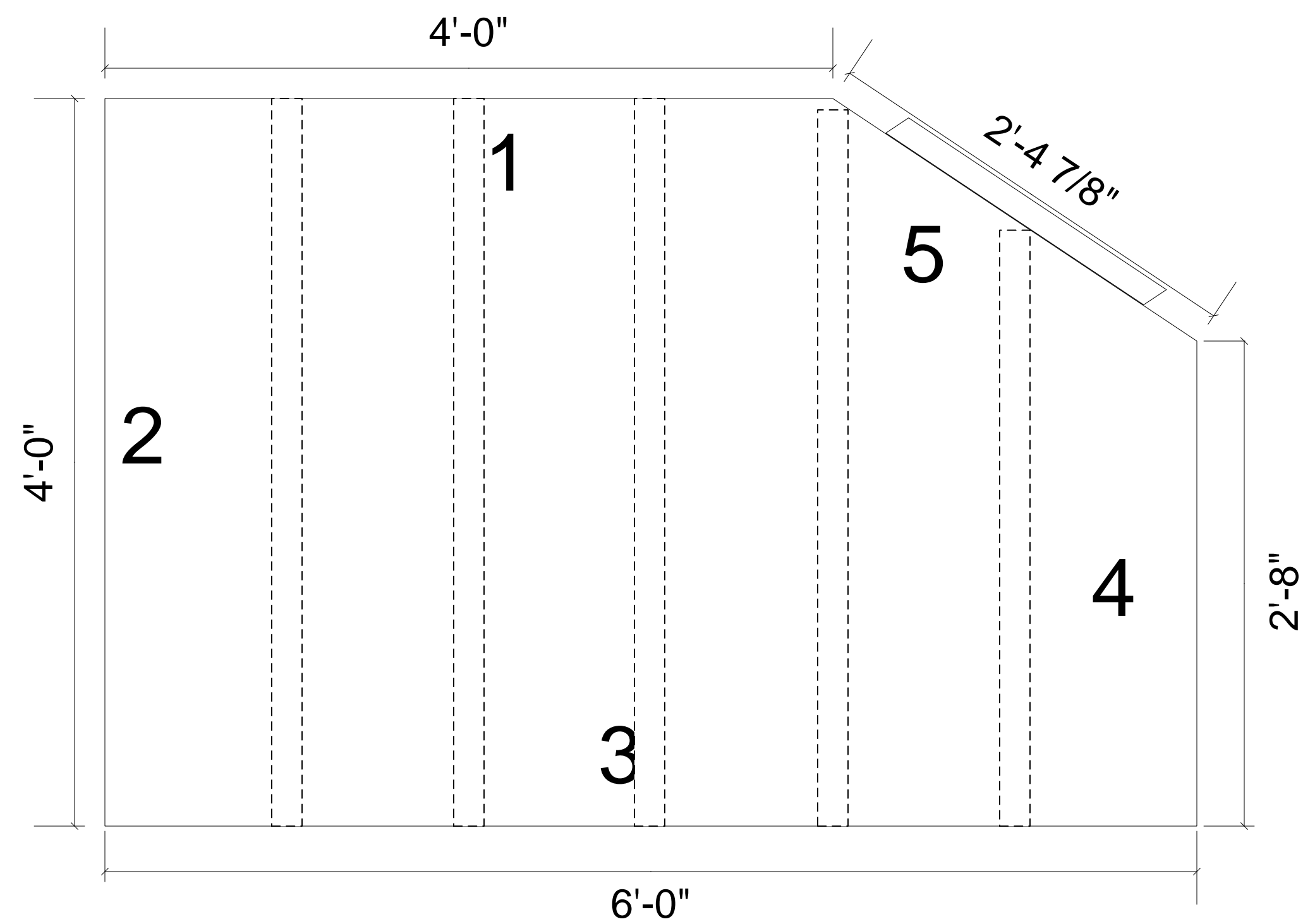

Ladder Materials:
 2"x4"x4'3" (2)
 2"x4"x2' (1)
 2"x3"x2' (4)

Total Materials:
 - 4'x8'x1/4" sanded plywood (1 Sheet)
 - 4'x8'x1/2" sanded plywood (1 sheet)
 - 1"x12"x8' pine board (1)
 - 1"x8"x8' pine board (3)
 - 2"x4"x8' (20)
 - 2"x3"x8' (1)